

## 5 series

Oil burners



12 - 60 kW



Yellow-flame burner, 1-stage with oil pre-heater, solenoid valve, nozzle (HVS 5.3 K without nozzle), integrated function light and sound insulation.

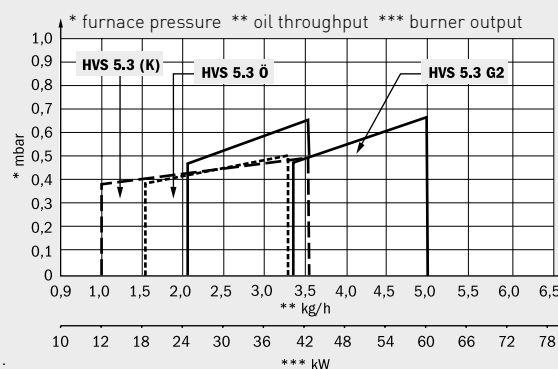
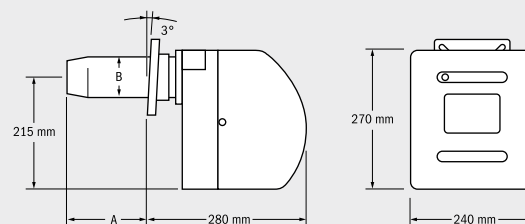

## 5 series fan-assisted oil burners

5 series fan-assisted oil burners are characterised by very smooth running and environmentally-friendly combustion. They are tested and approved according to EN 267 of the 1. BImSchV, suitable for the combustion of heating oil EL according to DIN 51603 with max. 6.0 cSt/293 K (50 °C).

The inbuilt oil pre-heater system ensures a uniform fuel temperature and optimum atomisation of the fuel. The air choke prevents fast cooling of the combustion chamber in case of standstill of the device. → An optimised high-performance fan guarantees a safe startup and a stable combustion. The air regulation at the suction and discharge side permits precise setting of the air volume even in the lower power range and the precision mixing system ensure simple but precise setting of the oil-air mixing ratio. Furthermore, the patented quick closure system, the practical maintenance positions and the variable installation depth is guarantee easy handling by means of a standard sliding flange.

| Model               | HVS 5.3 K        | HVS 5.3          | HVS 5.3 G2       | HVS 5.3 Ö        |
|---------------------|------------------|------------------|------------------|------------------|
| Flue                | 120 mm           | 172 mm           | 172 mm           | 174,5 mm         |
| BimSchV             | 1. BimSchV       | 1. BimSchV       | 1. BimSchV       | 1. BimSchV       |
| Burner output       | 12 - 43 kW       | 13 - 42 kW       | 40 - 60 kW       | 19 - 40 kW       |
| Oil throughput      | 1,3 - 3,5 kg / h | 1,3 - 3,5 kg / h | 3,3 - 5,0 kg / h | 1,5 - 3,3 kg / h |
| Power input         | ca. 160 W        | ca. 160 W        | ca. 160 W        | ca. 160 W        |
| Mains connection    | 230 V / 50 Hz    | 230 V / 50 Hz    | 230 V / 50 Hz    | 230 V / 50 Hz    |
| Weight              | 11,9 kg          | 12,0 kg          | 12,0 kg          | 11,9 kg          |
| (A) Insertion depth | 60 - 80 mm       | 60 - 130 mm      | 60 - 80 mm       | 60 - 130 mm      |
| (B) Flue diameter   | 80 mm            | 80 mm            | 90 mm            | 80 mm            |
| Order number        | 1000005          | 1000029          | 1000031          | 1000030          |
| <b>Price/€</b>      | <b>889.00</b>    | <b>932.00</b>    | <b>993.00</b>    | <b>932.00</b>    |

| Special equipment | Surcharge/€ |
|-------------------|-------------|
| Hot air version   | 139.00      |