

Series HSP Gas burner



20 - 70 kW



Natural gas burner with gas connection 1/2" - 20 mbar.

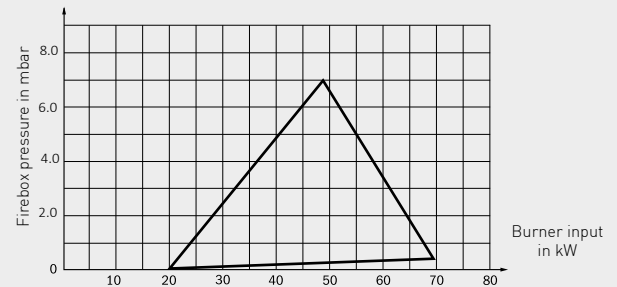
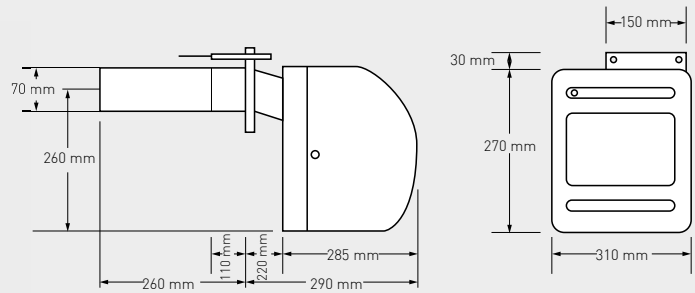

HSP gas forced draught burner

The Series HSP is the further development of the HANSA pre-mix gas burner with full gas-air modulation.

They are tested to EN 676 and have emissions below emission class 3, and are suitable for burning natural gas (H/L 20/50 mbar) and propane gas.

The pre-mix gas burner is continuously adjustable from 20-70 kW and is easy to install. Thanks to the efficient speed control, the HSP burner has low power consumption and is therefore extremely attractive for end customers.

All HSP gas burners are characterised by their resistance to gas pressure fluctuations and very quiet running.

Operation is also possible at low gas input pressures.

The function control and fault diagnostics can be read out digitally and therefore simplify handling. Highly stable pressure, good start behaviour and low-noise operation round of the advantages.

Model	HSP 1 E	HSP 1 E	HSP 1 F	HSP 1 F
Natural gas	X	X	---	---
Liquid gas	---	---	X	X
Gas connection	1/2"	1/2"	1/2"	1/2"
Burner output	20 - 36 kW	30 - 70 kW	20 - 36 kW	30 - 70 kW
Power consumption	180 W	180 W	180 W	180 W
Mains connection	230 V / 50 Hz	230 V / 50 Hz	230 V / 50 Hz	230 V / 50 Hz
Weight	7.5 kg	7.5 kg	7.5 kg	7.5 kg
Order number	1003924	1000089	1004043	1003143
Price/€	1,922.00	1,922.00	1,922.00	1,922.00